

CPM25APEQ | RoadVise® Clamp Mount with Universal Fish Finder Mount

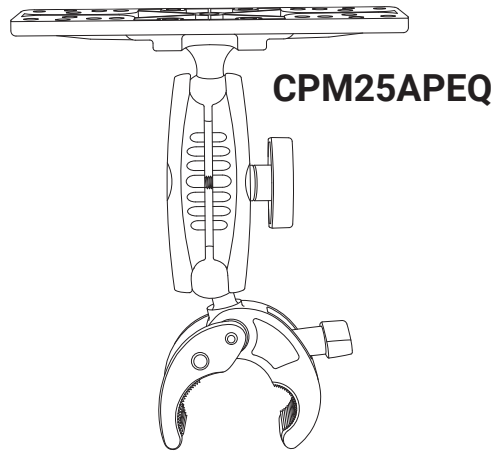

Includes:

- 1 – Manual
- 1 – Universal Fish Finder Mount Bracket (APEQUIP25MM)
- 1 – 25mm Robust Shaft Arm (SP-RM250)
- 1 – 25mm RoadVise Clamp (CPMHD)

Note: Screws are not included in the packaging for this product.

Important: Clean the application surface and make sure it is free of dirt, dust, and grease before installing the mounting hardware.

1

Assemble all the components

Locate the packaging containing the RoadVise clamp mount, Robust Shaft Arm, and Universal Fish Finder Mount Bracket. Once located, turn the knob counterclockwise on the 25mm Robust Shaft Arm to create space. Insert the RoadVise Clamp and Universal Fish Finder Mount Bracket, then tighten it by turning it clockwise.

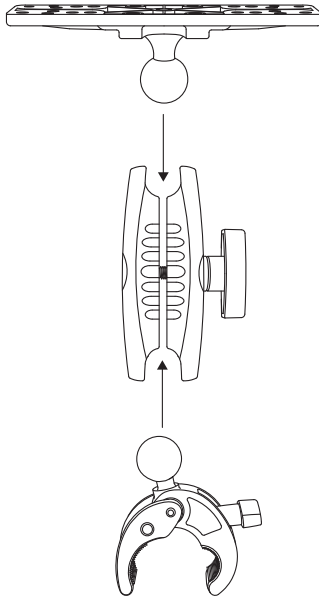

2

How to adjust the RoadVise clamp mount

Turn the knob on the clamp mount counterclockwise to expand the clamp arms to your desired width. Expand the arms by gently pulling them apart. Mount to your application surface and tighten the knob clockwise to secure.

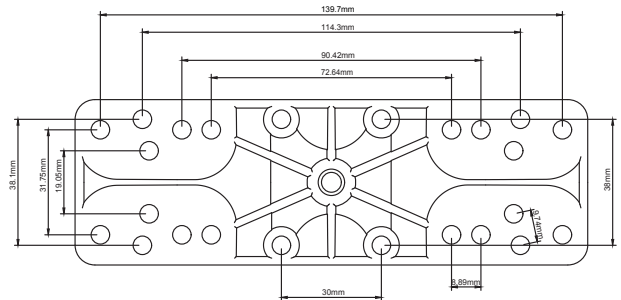
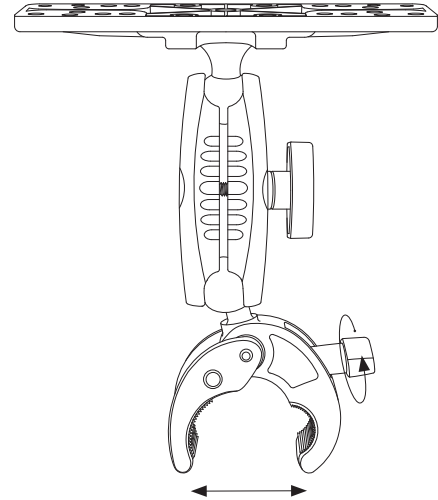

WARNING

CHOKING HAZARD - Keep out of reach from children under 8 yrs. as they can choke or suffocate on parts included with this system

WARNING

Arkon® is not responsible for any damages caused to your device or yourself due to the installation or use of this mount. Do not install Arkon® products near areas that interfere with operation of vehicles. Arkon® assumes no responsibility or liability for injury or death as a result of failure to install in a safe location. Arkon® is not responsible for any damages caused to vehicles, product, or people due to the installation or use of this product.

ARKON® MOUNTS

USA (800) 841-0884
INT'L (626) 254-9005
Monday - Friday 9 am - 5 pm PST

arkon.com
Designed in USA
©Arkon Resources, Inc.

Need assistance?
Scan to email our
Arkon® customer
service team.



- 5 Installing the tablet to the holder**
Apply the locking keys to unlock the height adjustment of the tablet holder. Pull up on the top arm to expand the holder.

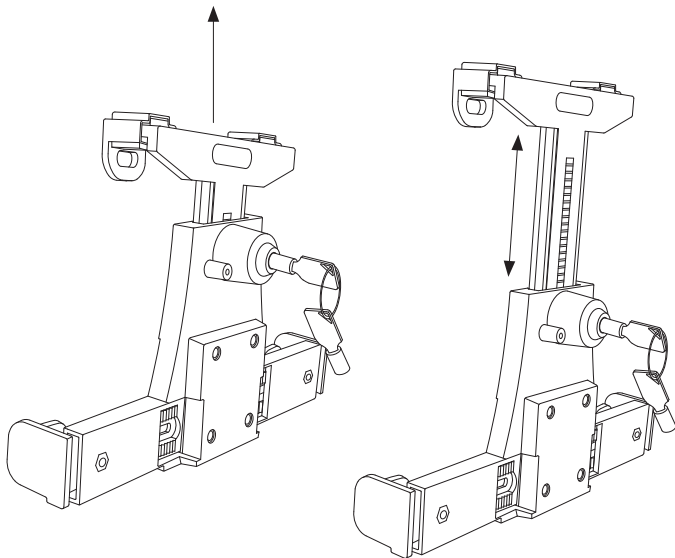

- 6 Locking the tablet into the holder**
To secure the tablet, insert it into the holder and adjust the top accordingly. Once the tablet is in position, push the button on the back to lock it in place.

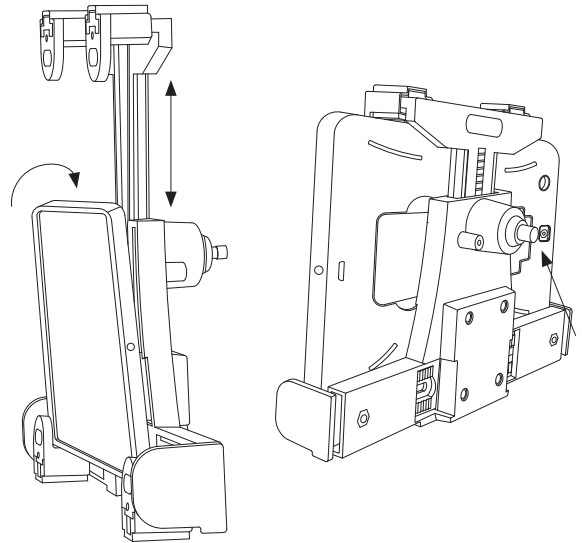

- 7 Optional - Installing the foam padding if not using a tablet case**
To properly set up the tablet holder, find the packaging that contains the foam padding and place it in the center of the holder.

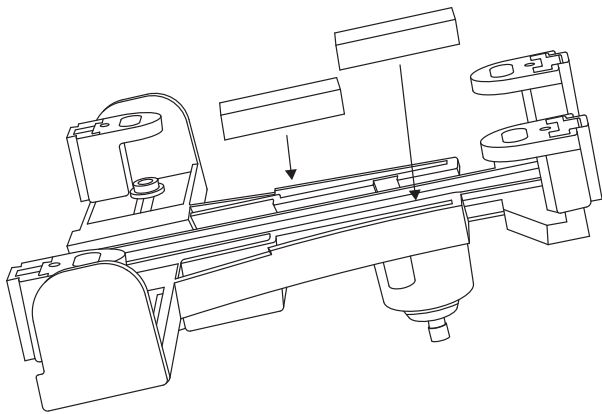

WARNING

CHOKING HAZARD - Keep out of reach from children under 8 yrs. as they can choke or suffocate on parts included with this system

WARNING

Arkon® is not responsible for any damages caused to your device or yourself due to the installation or use of this mount. Do not install Arkon® products near areas that interfere with operation of vehicles. Arkon® assumes no responsibility or liability for injury or death as a result of failure to install in a safe location. Arkon® is not responsible for any damages caused to vehicles, product, or people due to the installation or use of this product.

