

**Included Components:**

- A. 1x LockVise™ Locking Tablet Holder with Hardware Kit (TAB005KL)
- B. 1x Clamp with 12" Gooseneck - AMPS (GN086-12-SBH-AMPS)

**Tablet Compatibility**

4.11" - 7.88"	Wide
7.44" - 11.87"	Height

**Important:** Clean the application surface and make sure it is free of dirt, dust, and grease before installation.

**If you need a replacement part,** please refer to the **SKU** options below:

- **Tablet Holder Support Legs:** SPTAB6FT
- **Tightening Ring & AMPS Pattern Kit:** SP-SB-AMPS-KIT-22
- **Rubber Cover for the Clamp:** SPCLAMPCLR

**1 Align and Adjust the Clamp Width**

Position the clamp on the edge of the surface where you want to mount the system. The multi-hole design allows compatibility with a wide range of surfaces and setups.

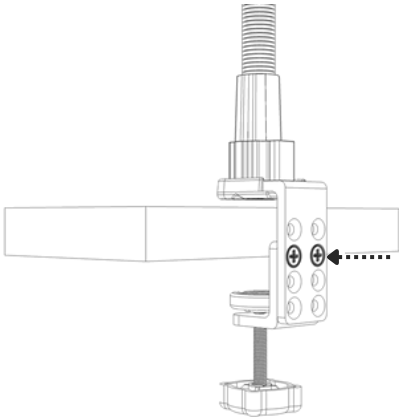

**2 Secure the Clamp**

Rotate the adjustment knob to open the clamp. Tighten the adjustment knob until the clamp is firmly secured to the surface. The durable clamp mechanism ensures your setup stays stable.

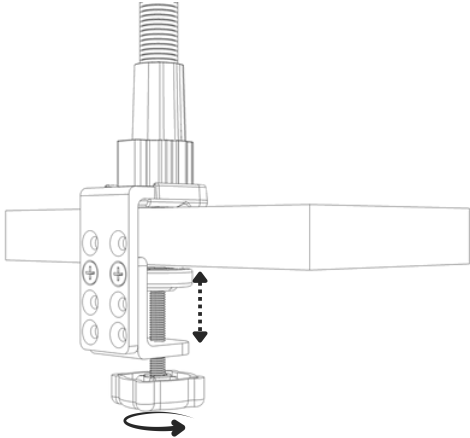

**3 AMPS Adapter Installation**

Locate the AMPS mounting pattern on the back of the holder. Align the AMPS adapter with the holes, insert the included screws, and tighten them until the adapter is securely attached.

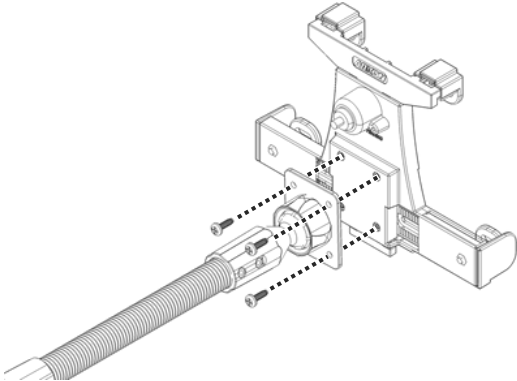

**WARNING**

CHOKING HAZARD - Keep out of reach from children under 8 yrs. as they can choke or suffocate on parts included with this system

**WARNING**

Arkon® is not responsible for any damages caused to your device or yourself due to the installation or use of this mount. Do not install Arkon® products near areas that interfere with operation of vehicles. Arkon® assumes no responsibility or liability for injury or death as a result of failure to install in a safe location. Arkon® is not responsible for any damages caused to vehicles, product, or people due to the installation or use of this product.

Continued on page 2



## Tablet Holder Installation Steps:

### 4 Adjusting the Length of the Tablet Holder

Use a Phillips screwdriver to loosen the adjustment screws. This will allow you to expand the width and depth of the holder to fit your device. Once adjusted, retighten the screws to secure the holder in place.

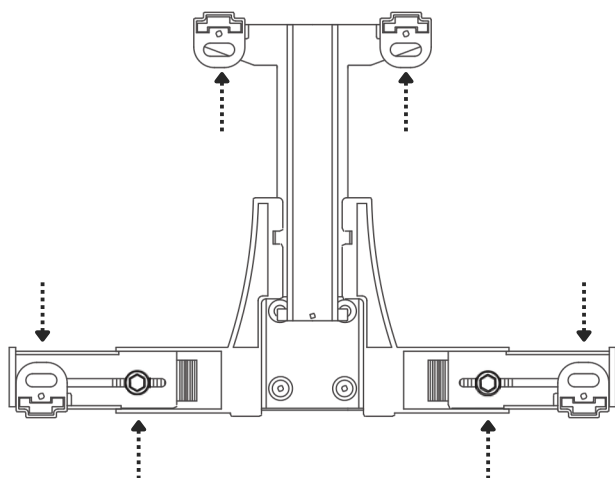

### 5 Installing the Tablet into the Holder

Insert the locking keys to release the height adjustment. Pull upward on the top arm to expand the holder, creating enough space to fit your tablet securely.

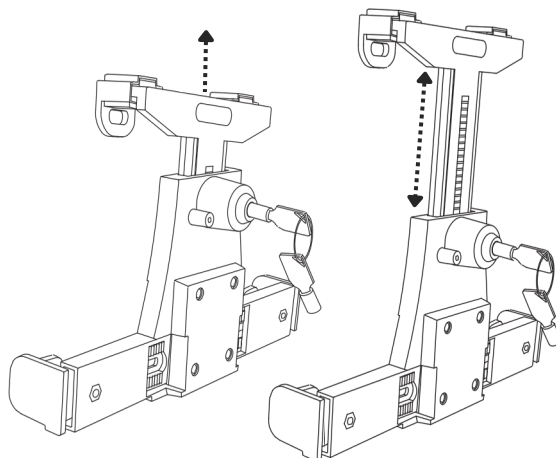

### 6 Locking the Tablet into the Holder

Place the tablet into the holder and adjust the top arm to fit snugly. Once the tablet is properly positioned, press the button on the back of the holder to lock it securely.

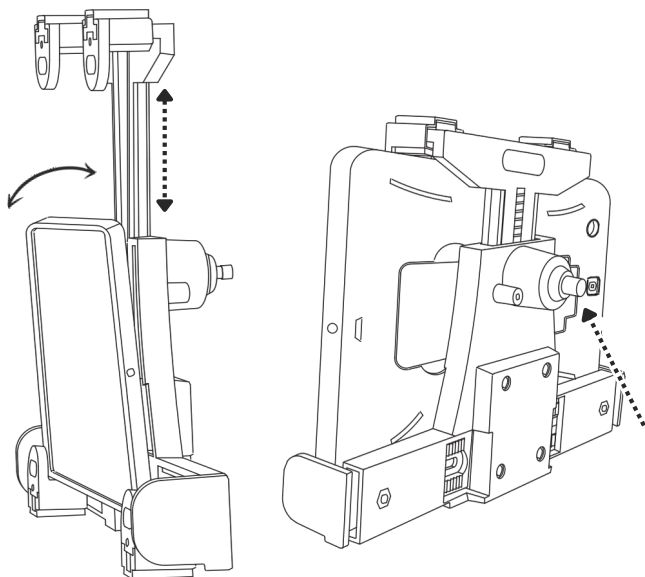

### 7 Optional – Installing Foam Padding

If you're not using a tablet case, locate the included foam padding from the packaging. Place the padding in the center of the holder to provide a secure and cushioned fit for your device.

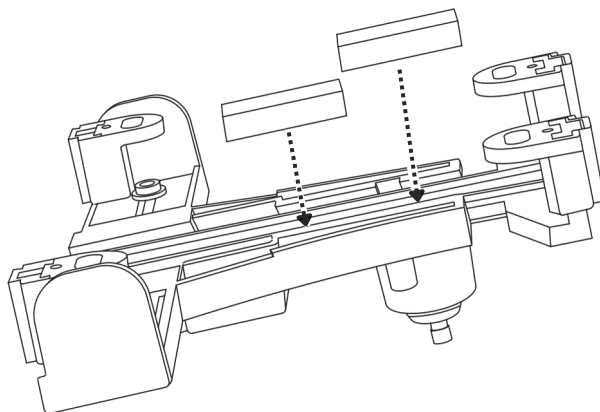

#### WARNING

CHOKING HAZARD - Keep out of reach from children under 8 yrs. as they can choke or suffocate on parts included with this system

#### WARNING

Arkon® is not responsible for any damages caused to your device or yourself due to the installation or use of this mount. Do not install Arkon® products near areas that interfere with operation of vehicles. Arkon® assumes no responsibility or liability for injury or death as a result of failure to install in a safe location. Arkon® is not responsible for any damages caused to vehicles, product, or people due to the installation or use of this product.

