

Included Components:

- A. 1x Slim-Grip® Ultra Pro Holder with Legs & Hardware (TAB006AMPSXL)
- B. 1x Clamp Pedestal with 4" Arm and AMPS Adapter (APMAMPS25MM)
- C. 1x OCTO™ Series 25mm Ball with Button Socket (SPRM8SKT)
- D. 1x OCTO™ Series Button to 4-Hole AMPS Adapter (SPRM8CBAMPS)

Tablet Size Approx.	Recommended Leg Combination
6.37" – 8.81"	2 Small Legs
7.12" – 9.25"	1 Long Leg + 1 Small Leg
7.62" – 10"	2 Long Legs
8.75" – 11.12"	1 Long Leg + 1 Extra-Long Leg

Important: Clean the application surface and make sure it is free of dirt, dust, and grease before installation.

- 1
- Install the AMPS Adapter Plate to the Holder**

Align the AMPS 4-hole adapter with the mounting holes on the back of the holder. Insert the four screws through the adapter plate and into the holder, then tighten securely to ensure a firm connection.

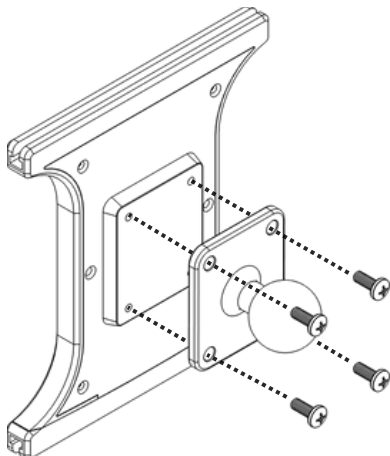

- 2
- Connect the Ball and Button Pattern Ends**

Rotate the knobs counterclockwise to loosen them. Attach the 25mm ball to one end and the button pattern to the opposite end of the assembly. Once both are properly aligned, turn the knobs clockwise to tighten and securely lock the components in place.

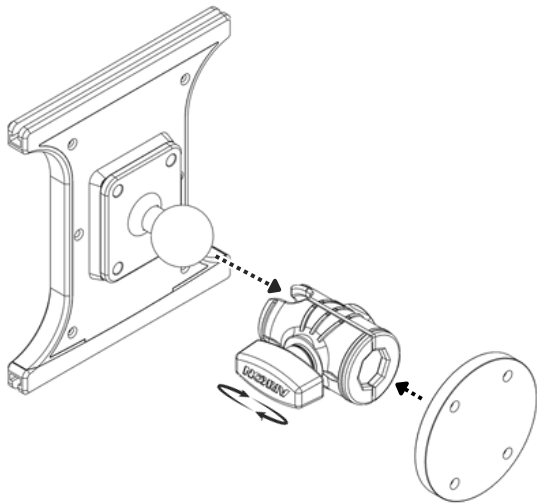

- 3
- Mount Installation**

Position the pedestal on the desired mounting surface. Using appropriate hardware (not included), securely fasten the pedestal to ensure a stable and reliable installation.

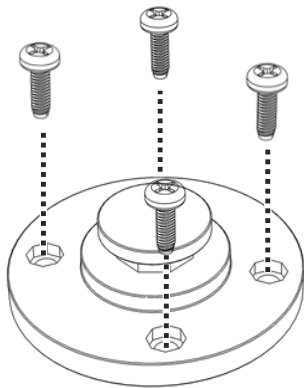

WARNING
CHOKING HAZARD - Keep out of reach from children under 8 yrs. as they can choke or suffocate on parts included with this system

WARNING
Arkon® is not responsible for any damages caused to your device or yourself due to the installation or use of this mount. Do not install Arkon® products near areas that interfere with operation of vehicles. Arkon® assumes no responsibility or liability for injury or death as a result of failure to install in a safe location. Arkon® is not responsible for any damages caused to vehicles, product, or people due to the installation or use of this product.

Continued on page 2



Tablet Holder Installation Steps:

4 Installing the Support Legs

Select the appropriate support legs based on the size guidelines provided on page 1. Then, insert each leg into the designated support leg channel on the holder and slide it in until it fits securely.

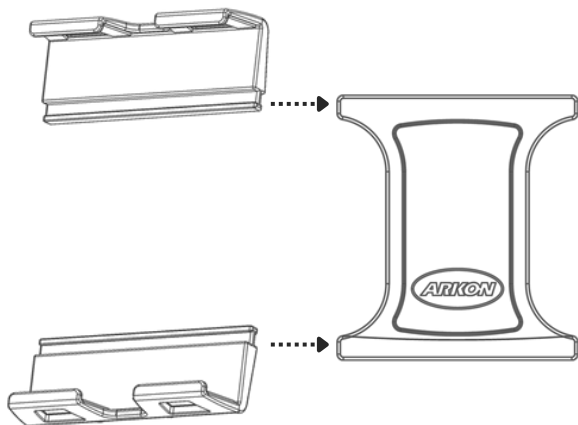

5 Extend the Spring-Load Mechanism

To extend the legs, insert one end of the tablet into the bottom support legs.

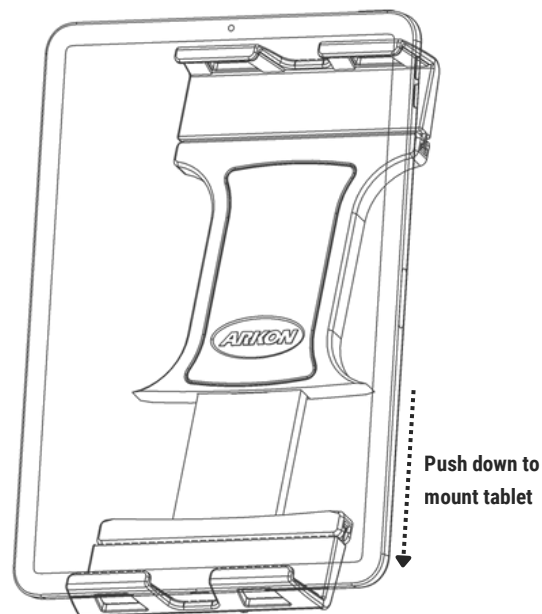

6 Install Your Tablet

With the holder's spring-loaded support legs expanded, lay the tablet flat on the holder.



7 Secure Your Tablet

Gently release the tablet into the holder, allowing the bottom spring-loaded support legs to secure the tablet.

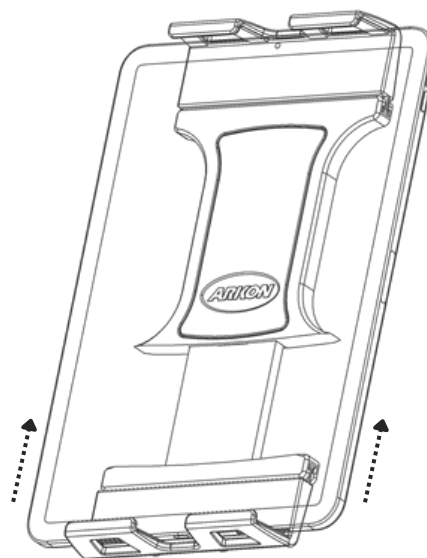

WARNING

CHOKING HAZARD - Keep out of reach from children under 8 yrs. as they can choke or suffocate on parts included with this system

WARNING

Arkon® is not responsible for any damages caused to your device or yourself due to the installation or use of this mount. Do not install Arkon® products near areas that interfere with operation of vehicles. Arkon® assumes no responsibility or liability for injury or death as a result of failure to install in a safe location. Arkon® is not responsible for any damages caused to vehicles, product, or people due to the installation or use of this product.

