

## Includes:

- 2 - OCTO™ Series 25mm Ball with Octagon Button Arm (SPRM8SKT)
- 1 - Metal 4-Hole AMPS to 25mm Ball Adapter (APMAMPS25MM)
- 1 - OCTO™ Series 2.5" Ratchet Elbow Arm (SPRM8RTE)
- 1 - Seat Rail Floor Mount with 25mm Ball (RM08825MM)

**Important:** Clean the application surface and make sure it is free of dirt, dust, and grease before installation.

## Seat Rail Kit Hardware Specifications:

- 1 - Metal conduit (SPCONDUIT)
- 1 - Floor mounting bracket
- 4 - Phillips rounded heads screws (18-8 Stainless Steel, M4.2 Screw Size 25mm Long)

## 1

### Option 1 - Mounting the Passenger Seat Bolt

Utilize a socket wrench to loosen the bolt on the passenger seat track. Then, insert the seat track bolt bracket. Finally, tighten the seat track bolt securely.

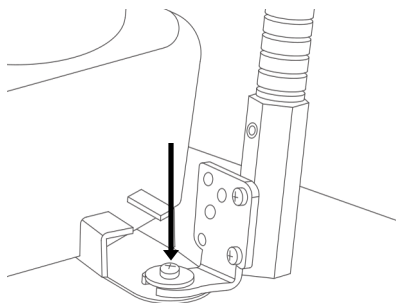
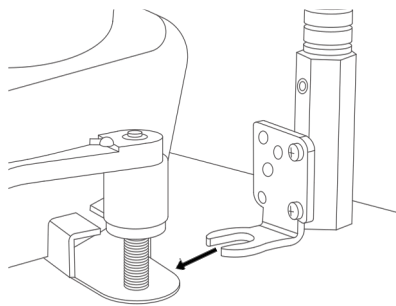
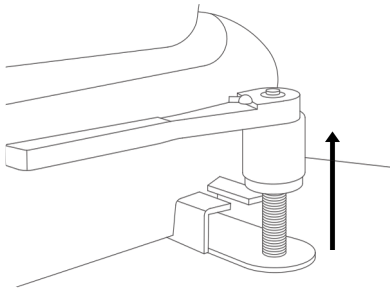

## 2

### Option 2 - Floor Mounting

Fasten the floor bracket to the mount. (Adjust the bracket's orientation as needed for your vehicle). Secure the floor/console bracket in place using screws.

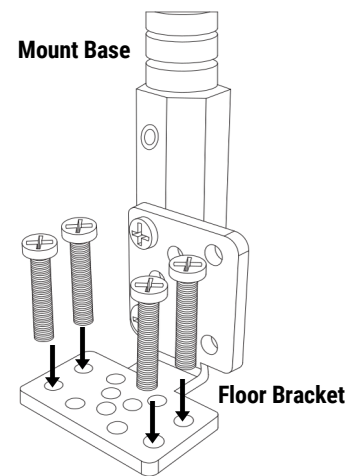
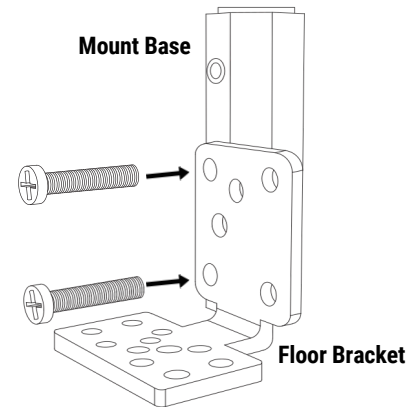

## WARNING

CHOKING HAZARD - Keep out of reach from children under 8 yrs. as they can choke or suffocate on parts included with this system

## WARNING

Arkon® is not responsible for any damages caused to your device or yourself due to the installation or use of this mount. Do not install Arkon® products near areas that interfere with operation of vehicles. Arkon® assumes no responsibility or liability for injury or death as a result of failure to install in a safe location. Arkon® is not responsible for any damages caused to vehicles, product, or people due to the installation or use of this product.

Continued on page 2



3

## Assemble the components

Locate the assembled arm and rotate both end knobs counterclockwise to loosen them. Next, attach the 25mm ball to each end. Finally, tighten the knobs to ensure that everything is securely in place.

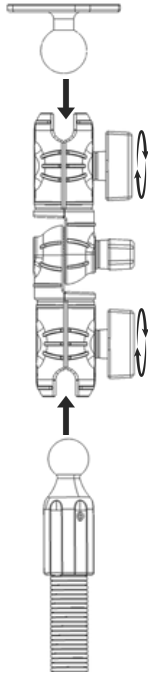

4

## Fully Assembled

Refer to the image below for the full assembled product.

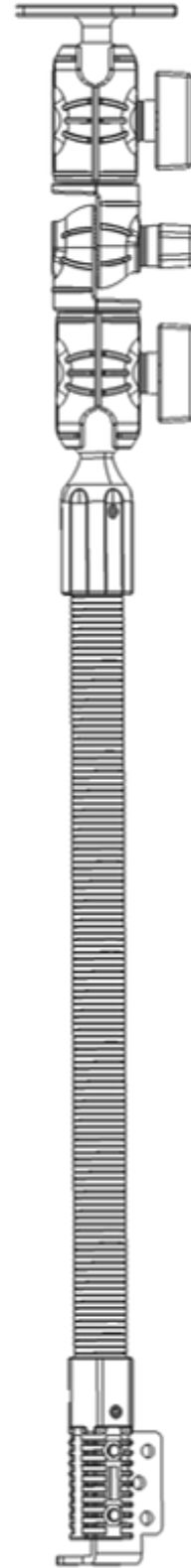

5

## Optional Step: Metal Conduit

Attach the included metal conduit to the console to help minimize vibration.

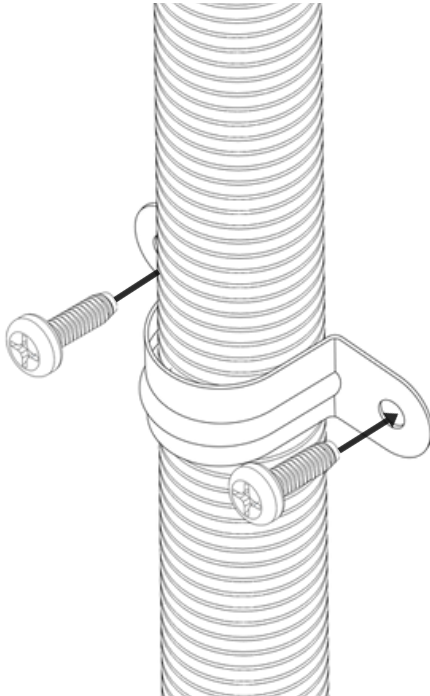

### WARNING

CHOKING HAZARD - Keep out of reach from children under 8 yrs. as they can choke or suffocate on parts included with this system

### WARNING

Arkon® is not responsible for any damages caused to your device or yourself due to the installation or use of this mount. Do not install Arkon® products near areas that interfere with operation of vehicles. Arkon® assumes no responsibility or liability for injury or death as a result of failure to install in a safe location. Arkon® is not responsible for any damages caused to vehicles, product, or people due to the installation or use of this product.

