

## Included Components:

- A. 1x RoadsVise® Ultra Pro Holder w/ AMPS Pattern (**RVPTAMPS**)
- B. 1x Metal AMPS Drill Pedestal with 3.75" Arm (**RM2XAMPS-MET**)

**Important:** Clean the application surface and make sure it is free of dirt, dust, and grease before installation.

### 1 Disassemble AMPS adapter plate from pedestal

To detach the AMPS adapter plate from the drill base pedestal, turn the shaft knob counterclockwise until the components separate.

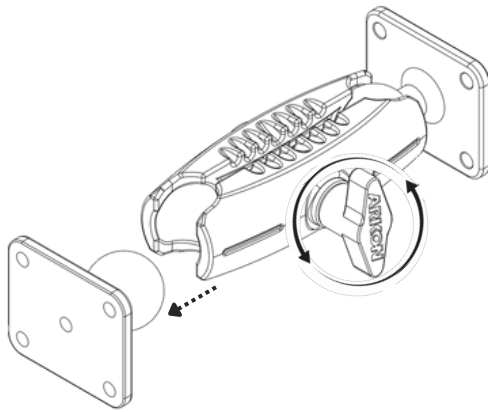

### 2 Install the AMPS adapter plate to the holder

Align the AMPS 4-hole adapter on the back of the holder. Then, insert the four mounting screws through the AMPS 4-hole ball adapter plate and into the holder. Finally, secure the screws tightly.

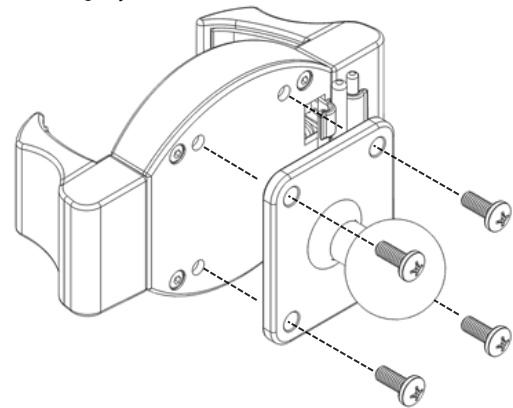

### 3 Mount installation

To secure the pedestal to the mounting surface, align the screws (**not included**) with the AMPS adapter. If necessary, detach the shaft from the adapter to streamline the installation process.

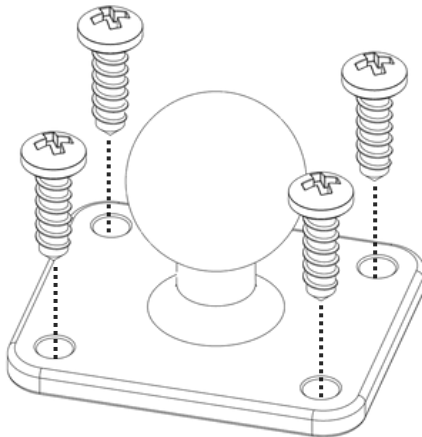

#### WARNING

CHOKING HAZARD - Keep out of reach from children under 8 yrs. as they can choke or suffocate on parts included with this system

#### WARNING

Arkon® is not responsible for any damages caused to your device or yourself due to the installation or use of this mount. Do not install Arkon® products near areas that interfere with operation of vehicles. Arkon® assumes no responsibility or liability for injury or death as a result of failure to install in a safe location. Arkon® is not responsible for any damages caused to vehicles, product, or people due to the installation or use of this product.

### 4 Assemble the components

Locate the shaft arm and turn to the adjustment knob counterclockwise to expand. Insert the 25mm ball ends into the shaft. Turn clockwise to tighten.

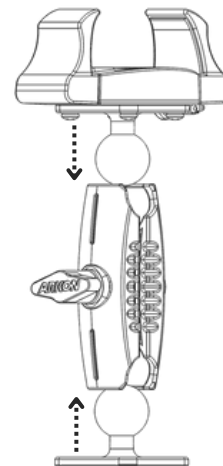

Continued on page 2

- 5

**Installing your device into the holder**

Place your device into the holder by pushing it into one of the spring-loaded arms. Expand the other arm to fully insert your device. Expand one arm, to remove device.

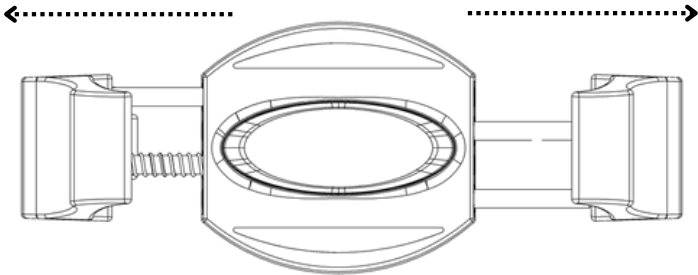

- 6

**Fully Assembled**

Refer to the image below for the full assembled product.

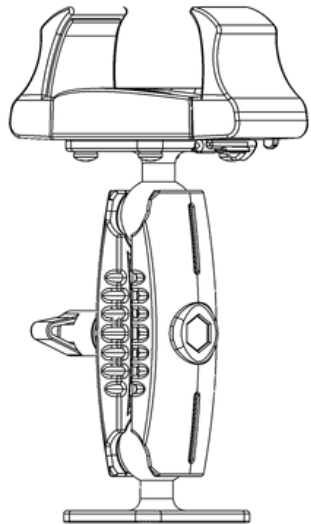

**WARNING**

CHOKING HAZARD - Keep out of reach from children under 8 yrs. as they can choke or suffocate on parts included with this system

**WARNING**

Arkon® is not responsible for any damages caused to your device or yourself due to the installation or use of this mount. Do not install Arkon® products near areas that interfere with operation of vehicles. Arkon® assumes no responsibility or liability for injury or death as a result of failure to install in a safe location. Arkon® is not responsible for any damages caused to vehicles, product, or people due to the installation or use of this product.

